

WELCOME to the new
BIG

NIHR Leeds Biomedical Research Centre

Professor Philip Conaghan
Director, NIHR Leeds BRC



What is the NIHR's mission?



NIHR's mission is to improve the health and wealth of the nation through research.

What is a BRC?

World leading centres of excellence that

- drive innovation in the prevention, diagnosis and treatment of ill-health
- deliver experimental/translational medicine research
- translate advances in biomedical research into benefits for patients
- provide a key component of the NHS contribution to our nation's international competitiveness by making the best Centres even better

NIHR Biomedical Research Centres



London

- 1 NIHR Barts Biomedical Research Centre
- 2 NIHR Great Ormond Street Hospital Biomedical Research Centre
- 3 NIHR Imperial Biomedical Research Centre
- 4 NIHR Maudsley Biomedical Research Centre
- 5 NIHR Moorfields Biomedical Research Centre
- 6 NIHR The Royal Marsden Biomedical Research Centre
- 7 NIHR University College London Hospitals Biomedical Research Centre

The NIHR research infrastructure – One NIHR

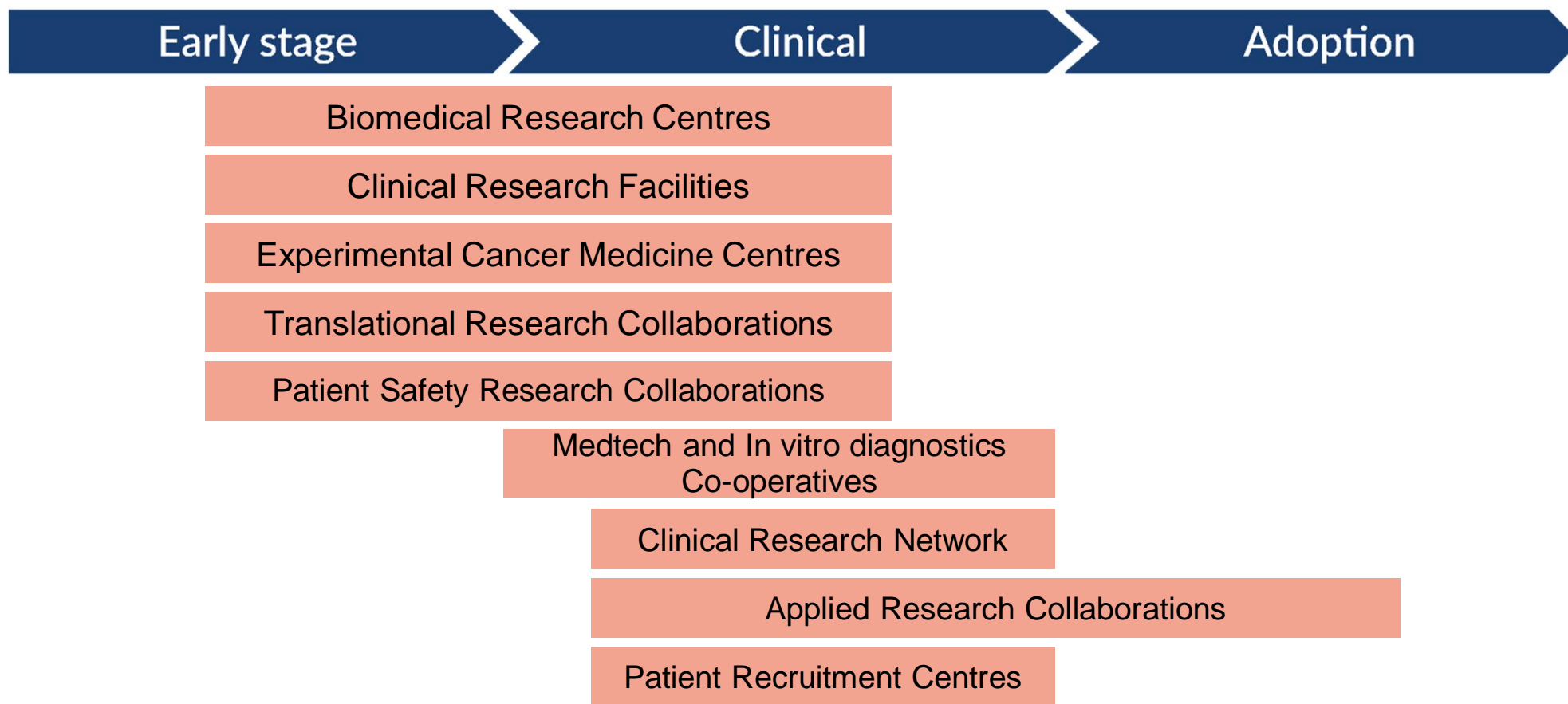

Wider UK research landscape

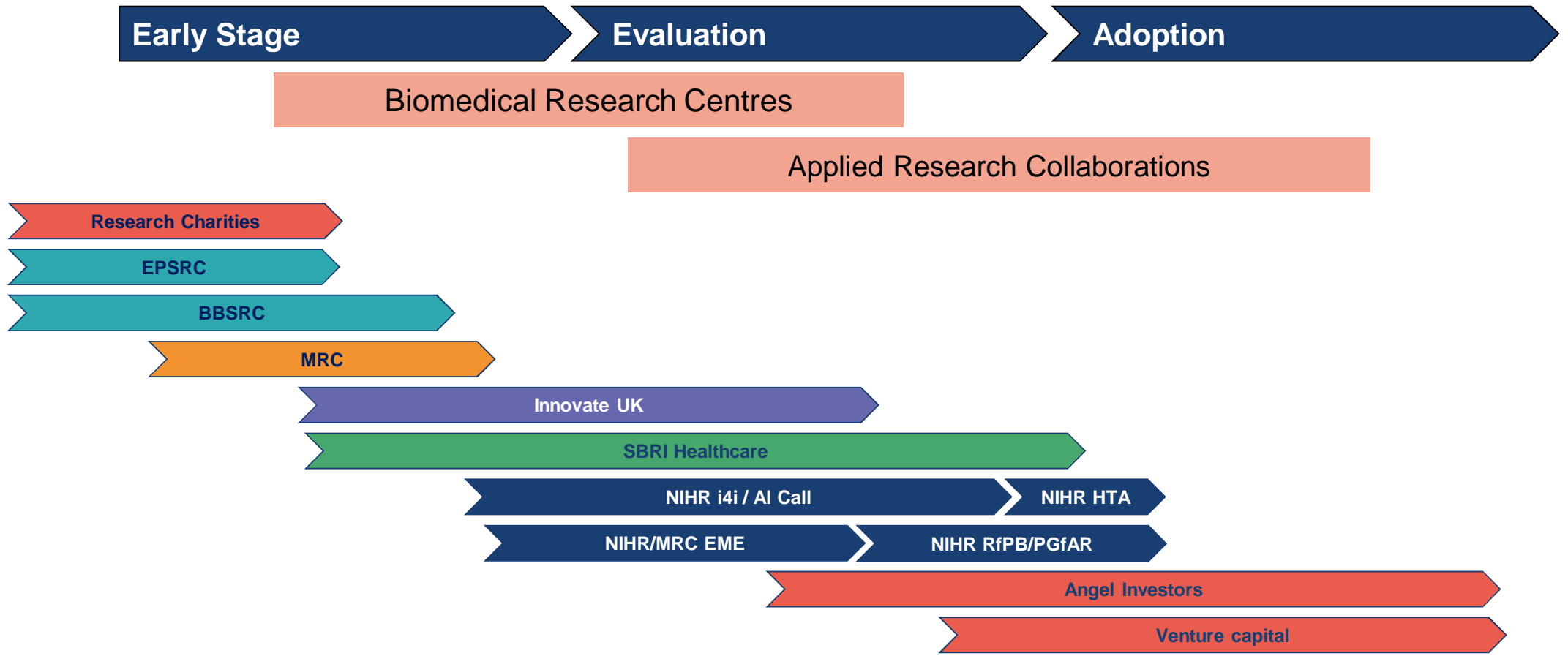

History of the Leeds BRU/C

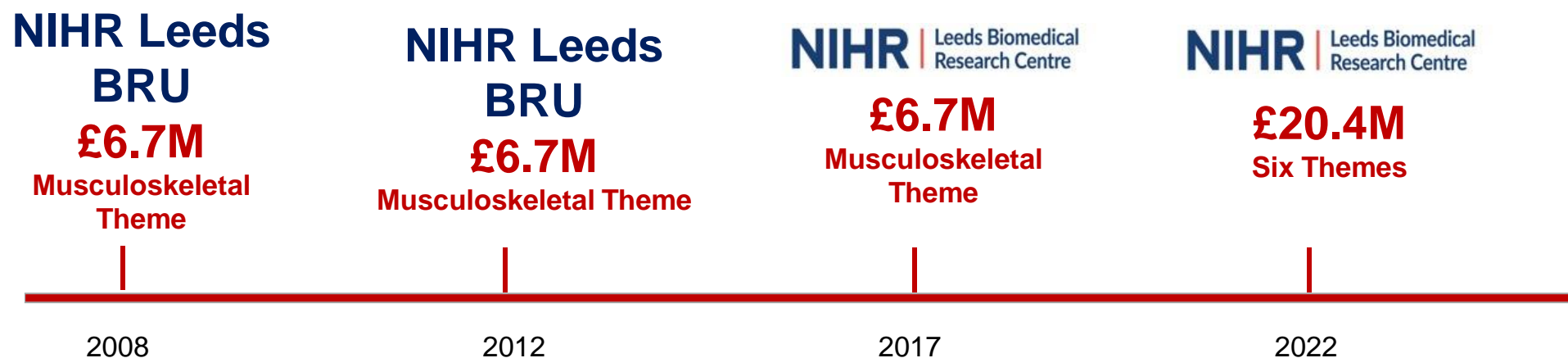

Leeds BRC: Our Partners

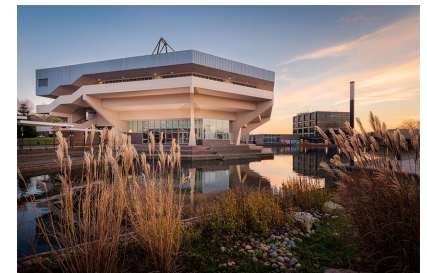

- A UK top research-intensive University (10th nationally for research power)
- 90% of research either 'world leading' or 'internationally excellent'
- Annual research income of £140M
- One of the largest NHS Trust in the UK
 - 20,000 employees
 - 1.2 million patients each year
 - Annual turnover of £1.3b
- Joint 10th of UK universities for research quality (REF 2021).
- Annual research income over £100M

Leeds BRC: Our Strategy

The goal of the BRC is that all activities are

- Patient-led, in terms of prioritising, designing and conducting research, with a focus on patients who are in most need
- Aimed at increasing the speed at which research is adopted, is cost-effective and designed for each individual patient
- Collaborative, enabling a wide range of clinicians and researchers to maximise the quality and impact of the research
- Undertaken in respect of our values of equality, diversity and inclusion
- Developed to attract, develop, support and retain our research leaders of the future

Leeds BRC: Our Themes



Cross cutting capabilities:
PPIE, Data/AI and trial methodology

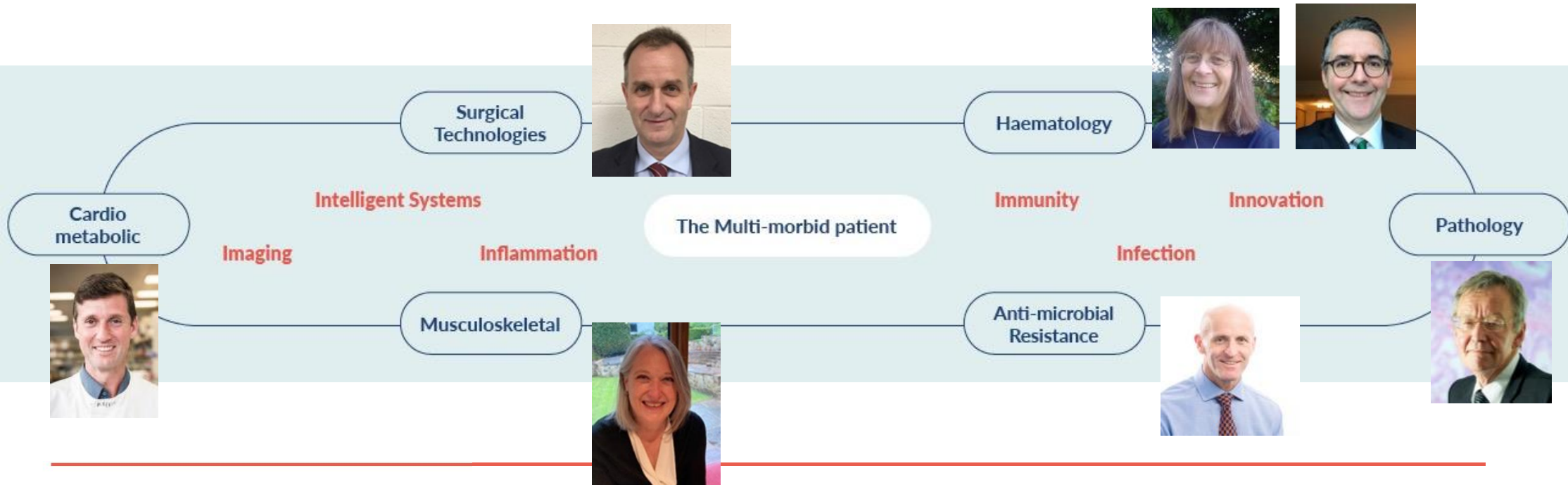

Leeds BRC: Our Core Team



Steve Rose
BRC Operations Director



Medina Inamdar
BRC Operations Manager



Georgina Davis
BRC Operations Coordinator



Alex Lavigne
BRC Business Manager



Amy Rebane
BRC PPIEP Lead



Anne-Maree Kennan and Carole Burnett
BRC Academic capacity Development co-Leads



Cynthia Iglesias
BRC EDI Lead



Julia Brown
Trials & Methodology Lead



Francesco Del Galdo
Clinical IT lead



Ruben Mujica-Mota
Health Economist Lead



Richard Wakefield
Ultrasound Lead



Philip Robinson
MR Lead (designate)



NIHR | Leeds Biomedical
Research Centre